

LIGHTFIELD ENTERPRISES, INC.
Concrete & Construction Services

NOT AN ENGINEER

MHT #1 DATE 4/26/2022
Page 1 of 3

PRIME CONTRACTOR: Town of Timnath
CONTACT: Callie Hoppe NUMBER: 970-980-4501

JOB NAME: 4th of July

JOB LOCATION: Timnath, CO

ATTSA CERT # 80195 ATTSA EXP - 3/03/2026

MHT PREPARED BY: *David A. Brostrom*

TOWN OF TIMNATH

David A. Brostrom
LEI TRAFFIC CONTROL SERVICES

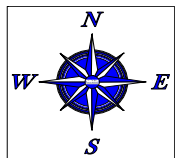

**TOWN OF TIMNATH - 4TH OF JULY
ADVANCE WARNING PLAN**

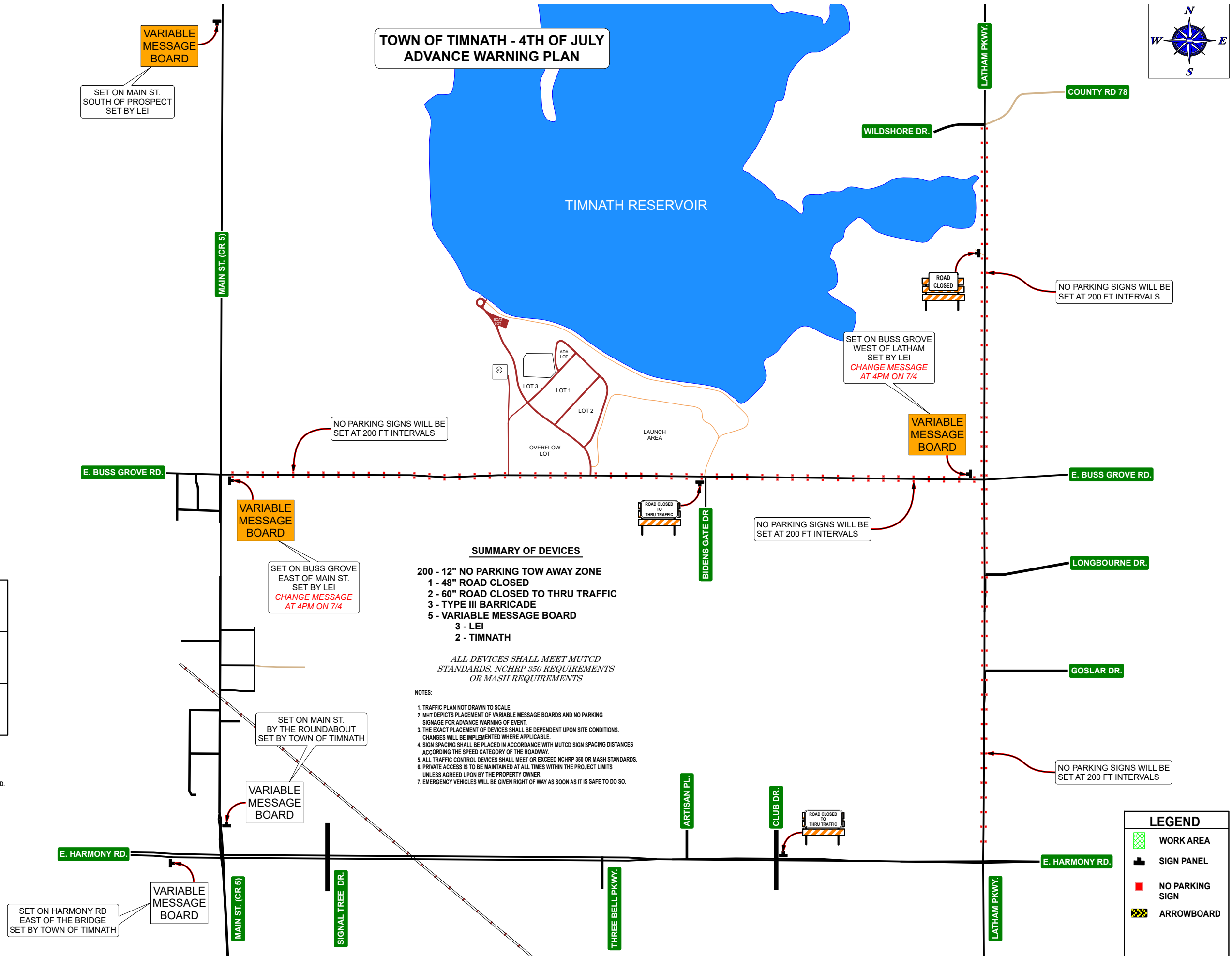

- SUMMARY OF DEVICES**
- 200 - 12" NO PARKING TOW AWAY ZONE
 - 1 - 48" ROAD CLOSED
 - 2 - 60" ROAD CLOSED TO THRU TRAFFIC
 - 3 - TYPE III BARRICADE
 - 5 - VARIABLE MESSAGE BOARD
 - 3 - LEI
 - 2 - TIMNATH

ALL DEVICES SHALL MEET MUTCD STANDARDS, NCHRP 350 REQUIREMENTS OR MASH REQUIREMENTS

- NOTES:**
1. TRAFFIC PLAN NOT DRAWN TO SCALE.
 2. MHT DEPICTS PLACEMENT OF VARIABLE MESSAGE BOARDS AND NO PARKING SIGNAGE FOR ADVANCE WARNING OF EVENT.
 3. THE EXACT PLACEMENT OF DEVICES SHALL BE DEPENDENT UPON SITE CONDITIONS. CHANGES WILL BE IMPLEMENTED WHERE APPLICABLE.
 4. SIGN SPACING SHALL BE PLACED IN ACCORDANCE WITH MUTCD SIGN SPACING DISTANCES ACCORDING TO THE SPEED CATEGORY OF THE ROADWAY.
 5. ALL TRAFFIC CONTROL DEVICES SHALL MEET OR EXCEED NCHRP 350 OR MASH STANDARDS.
 6. PRIVATE ACCESS IS TO BE MAINTAINED AT ALL TIMES WITHIN THE PROJECT LIMITS UNLESS AGREED UPON BY THE PROPERTY OWNER.
 7. EMERGENCY VEHICLES WILL BE GIVEN RIGHT OF WAY AS SOON AS IT IS SAFE TO DO SO.

Message Board Sequencing

Advance Warning	During Closure

- MESSAGE BOARD NOTES:**
1. VARIABLE MESSAGE BOARDS WILL BE PLACED WED., JUNE 29TH.
 2. VMB MESSAGING WILL BE PROVIDED BY THE TOWN OF TIMNATH.
 3. CHANGE VMB MESSAGE ON THE TWO (2) VMB'S LOCATED ON BUSS GROVE RD. AT 4:00PM ON JULY 4TH.

LEGEND

- WORK AREA
- SIGN PANEL
- NO PARKING SIGN
- ARROWBOARD

 <p>Concrete & Construction Services</p>	
<p>NOT AN ENGINEER</p>	
<p>MHT #1 Page 2 of 3</p>	<p>DATE 4/26/2022</p>
<p>PRIME CONTRACTOR: Town of Timnath CONTACT: Callie Hoppe NUMBER: 970-980-4501</p>	
<p>JOB NAME: 4th of July</p>	
<p>JOB LOCATION: Timnath, CO</p>	
<p>ATTSA CERT # 80195 ATTSA EXP - 3/03/2026</p>	
<p>MHT PREPARED BY: <i>David A. Brostrom</i></p>	
<p>TOWN OF TIMNATH</p>	
<p><i>David A. Brostrom</i> LEI TRAFFIC CONTROL SERVICES</p>	

**TOWN OF TIMNATH - 4TH OF JULY
EVENT PARKING - INBOUND**

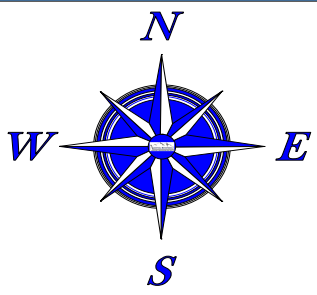

**TIMNATH
RESERVOIR**

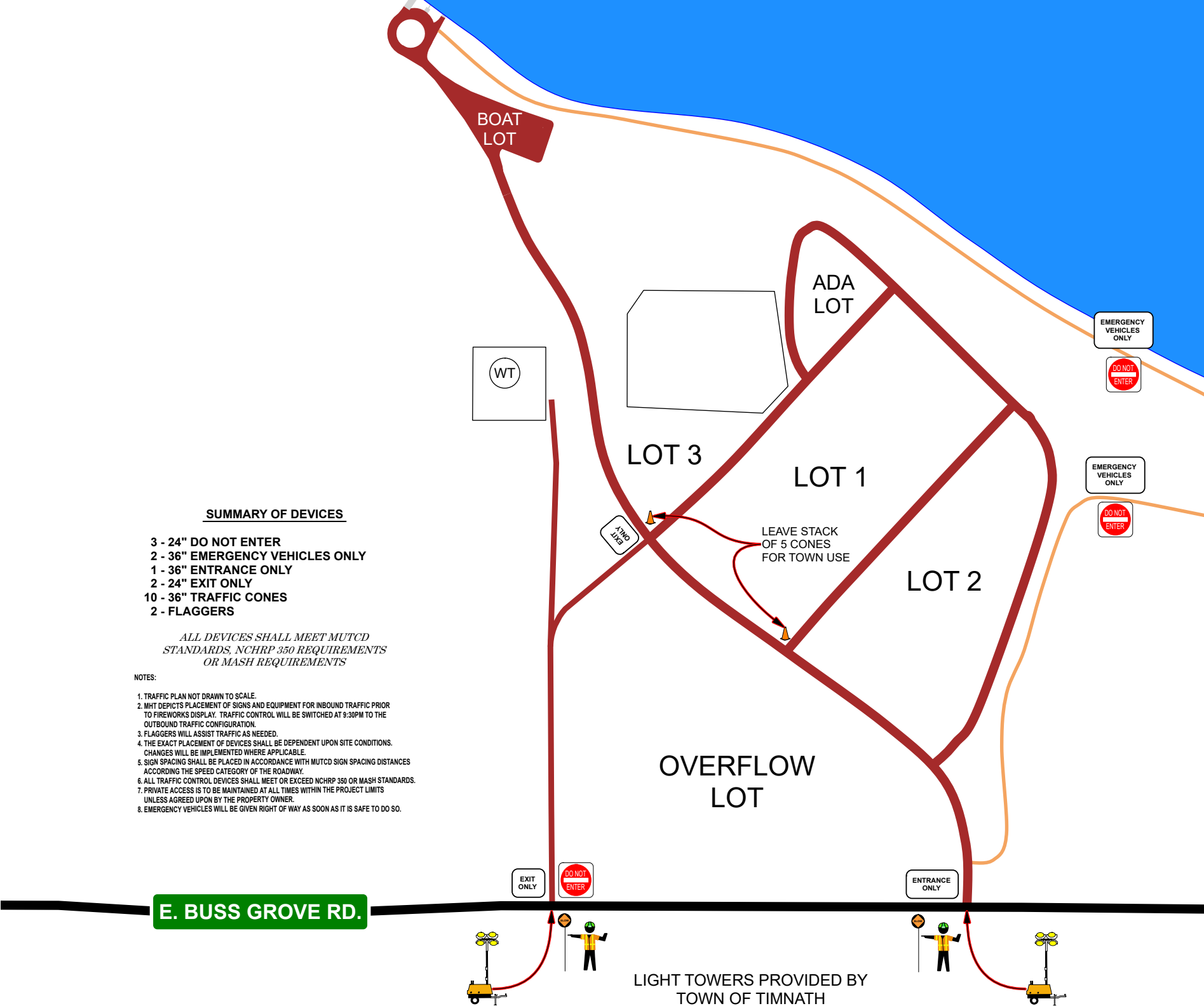

SUMMARY OF DEVICES

- 3 - 24" DO NOT ENTER
- 2 - 36" EMERGENCY VEHICLES ONLY
- 1 - 36" ENTRANCE ONLY
- 2 - 24" EXIT ONLY
- 10 - 36" TRAFFIC CONES
- 2 - FLAGGERS



ALL DEVICES SHALL MEET MUTCD STANDARDS, NCHRP 350 REQUIREMENTS OR MASH REQUIREMENTS

NOTES:

1. TRAFFIC PLAN NOT DRAWN TO SCALE.
2. MHT DEPICTS PLACEMENT OF SIGNS AND EQUIPMENT FOR INBOUND TRAFFIC PRIOR TO FIREWORKS DISPLAY. TRAFFIC CONTROL WILL BE SWITCHED AT 9:30PM TO THE OUTBOUND TRAFFIC CONFIGURATION.
3. FLAGGERS WILL ASSIST TRAFFIC AS NEEDED.
4. THE EXACT PLACEMENT OF DEVICES SHALL BE DEPENDENT UPON SITE CONDITIONS. CHANGES WILL BE IMPLEMENTED WHERE APPLICABLE.
5. SIGN SPACING SHALL BE PLACED IN ACCORDANCE WITH MUTCD SIGN SPACING DISTANCES ACCORDING TO THE SPEED CATEGORY OF THE ROADWAY.
6. ALL TRAFFIC CONTROL DEVICES SHALL MEET OR EXCEED NCHRP 350 OR MASH STANDARDS.
7. PRIVATE ACCESS IS TO BE MAINTAINED AT ALL TIMES WITHIN THE PROJECT LIMITS UNLESS AGREED UPON BY THE PROPERTY OWNER.
8. EMERGENCY VEHICLES WILL BE GIVEN RIGHT OF WAY AS SOON AS IT IS SAFE TO DO SO.

E. BUSS GROVE RD.

LIGHT TOWERS PROVIDED BY TOWN OF TIMNATH (MAY NEED TO BE TURNED ON BY LEI PERSONNEL)

LEGEND	
	WORK AREA
	SIGN PANEL
	NO PARKING SIGN
	ARROWBOARD

LIGHTFIELD ENTERPRISES, INC.
Concrete & Construction Services

NOT AN ENGINEER

MHT #1 DATE 4/26/2022
Page 3 of 3

PRIME CONTRACTOR: Town of Timnath
CONTACT: Callie Hoppe NUMBER: 970-980-4501

JOB NAME: 4th of July

JOB LOCATION: Timnath, CO

ATTSA CERT # 80195 ATTSA EXP - 3/03/2026

MHT PREPARED BY: *David A. Brostrom*

TOWN OF TIMNATH

David A. Brostrom
LEI TRAFFIC CONTROL SERVICES

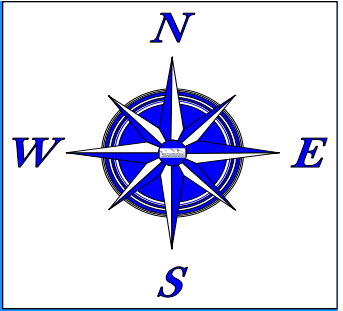

**TOWN OF TIMNATH - 4TH OF JULY
EVENT PARKING - OUTBOUND**

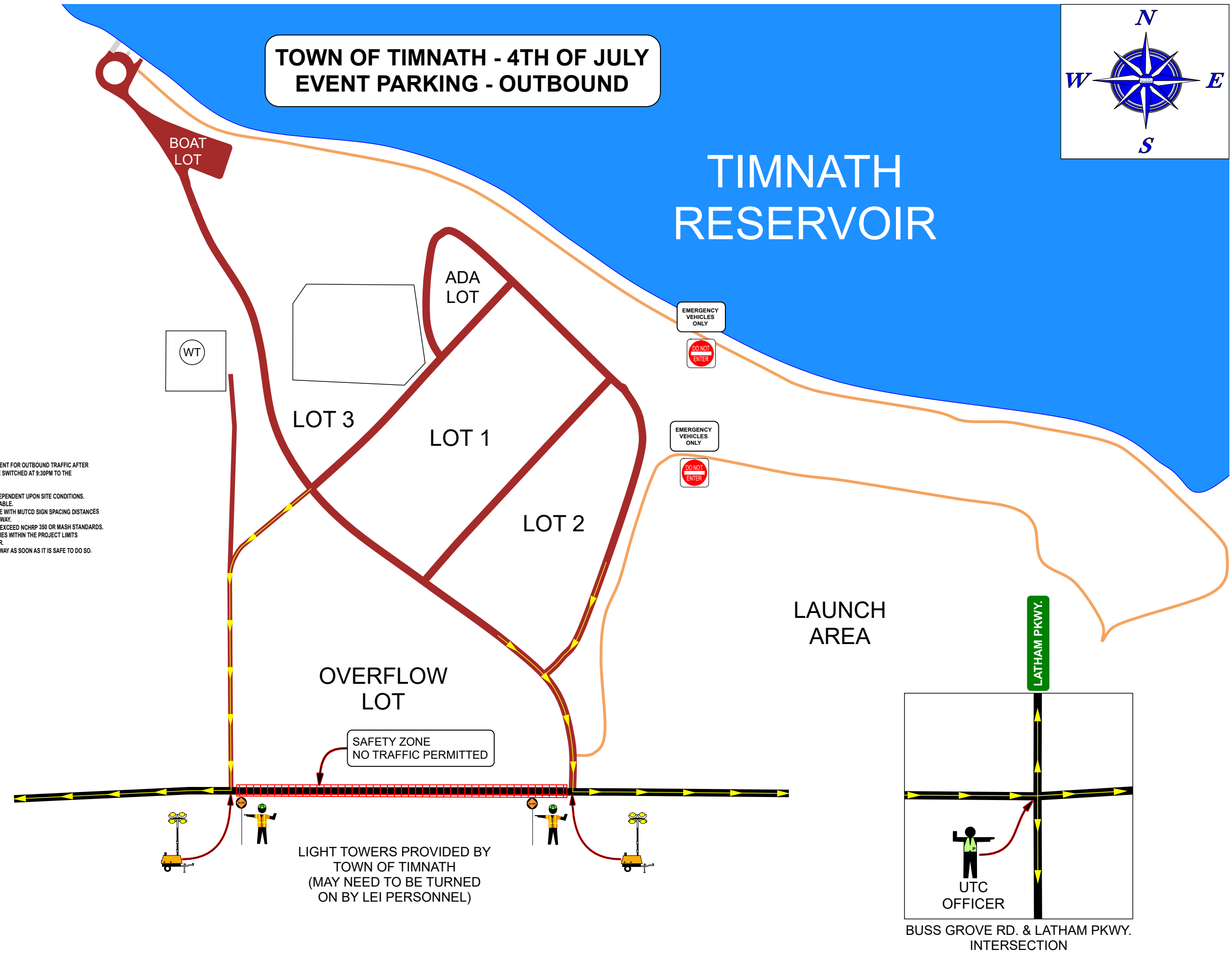

- NOTES:
1. TRAFFIC PLAN NOT DRAWN TO SCALE.
 2. MHT DEPICTS PLACEMENT OF SIGNS AND EQUIPMENT FOR OUTBOUND TRAFFIC AFTER FIREWORKS DISPLAY. TRAFFIC CONTROL WILL BE SWITCHED AT 9:30PM TO THE OUTBOUND TRAFFIC CONFIGURATION.
 3. FLAGGERS WILL ASSIST TRAFFIC AS NEEDED.
 4. THE EXACT PLACEMENT OF DEVICES SHALL BE DEPENDENT UPON SITE CONDITIONS. CHANGES WILL BE IMPLEMENTED WHERE APPLICABLE.
 5. SIGN SPACING SHALL BE PLACED IN ACCORDANCE WITH MUTCD SIGN SPACING DISTANCES ACCORDING TO THE SPEED CATEGORY OF THE ROADWAY.
 6. ALL TRAFFIC CONTROL DEVICES SHALL MEET OR EXCEED NCHRP 350 OR MASH STANDARDS.
 7. PRIVATE ACCESS IS TO BE MAINTAINED AT ALL TIMES WITHIN THE PROJECT LIMITS UNLESS AGREED UPON BY THE PROPERTY OWNER.
 8. EMERGENCY VEHICLES WILL BE GIVEN RIGHT OF WAY AS SOON AS IT IS SAFE TO DO SO.

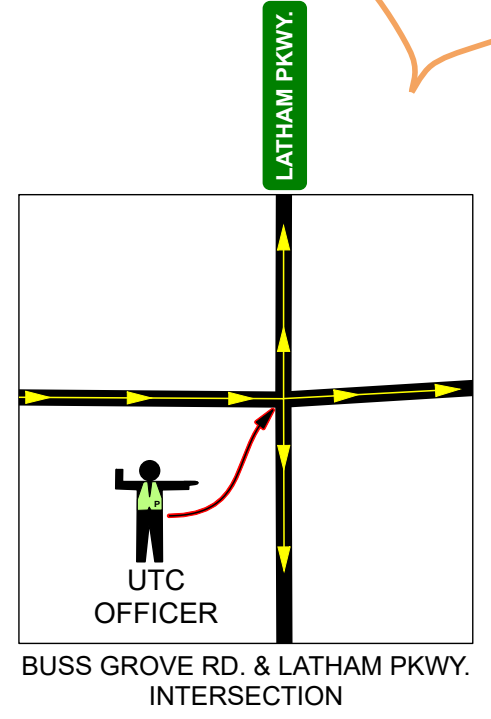
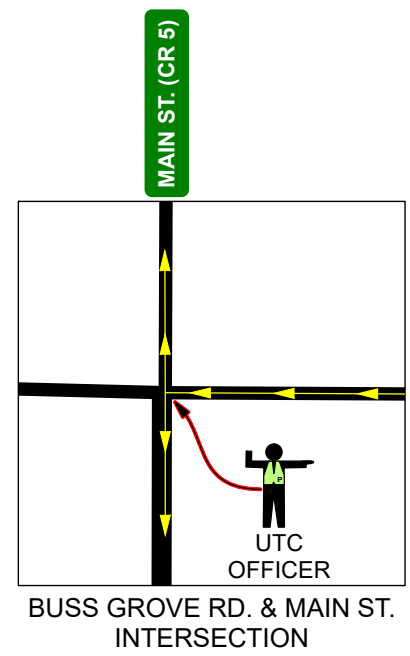

LIGHT TOWERS PROVIDED BY TOWN OF TIMNATH (MAY NEED TO BE TURNED ON BY LEI PERSONNEL)