

AMY - TR 7

150 Cones Used

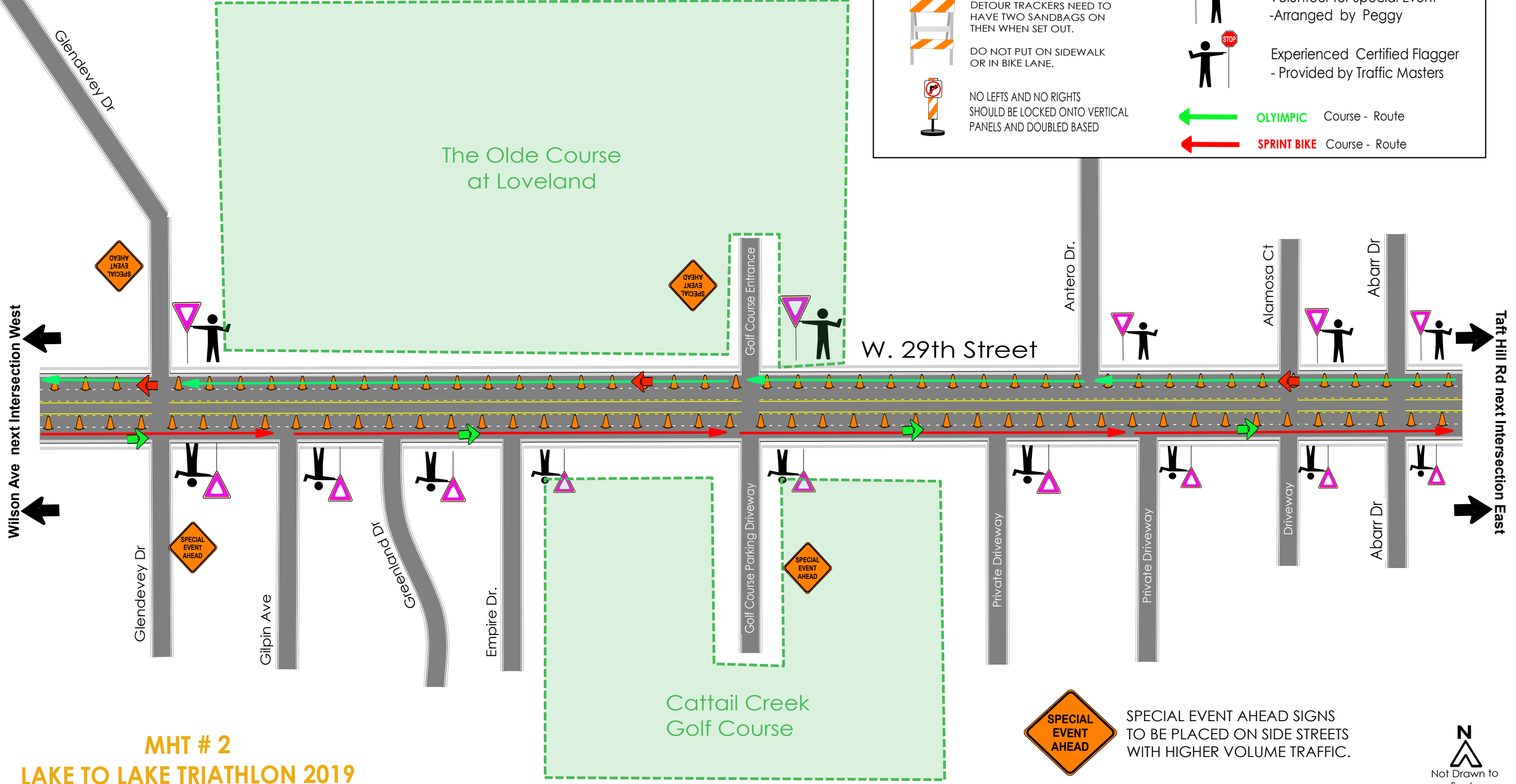

Wilson Ave next Intersection West

Taft Hill Rd next Intersection East

MHT # 2 LAKE TO LAKE TRIATHLON 2019

	Date: 12-5-2018 Author: Amy Wager-Tjardes
	Comments: - WILL LEAVE AS MUCH ACCESS AS POSSIBLE TO RESIDENTS HOMES AND BUSINESSES - ALL SIGNS AND DEVICES WILL CONFORM TO MUTCD STANDARDS - SIGN SPACING WILL BE DETERMINED BY TABLE 6H-3 IN THE MUTCD - OPERATION WILL BE ADJUSTED AS NEEDED FOR OPERATIONS IN PROGRESS - ALL PRE WARNING SIGNS WILL BE ADJUSTED FOR SIGNAGE ALREADY IN PLACE

Contractor:	Peggy Shockley
Location:	Loveland CO, Various roadways
Project/P.O.:	Lake To Lake Triathlon 2018
Contact/# :	Peggy Shockley 970-669-9011
Type of Work:	Special Event Triathlon

Comments: 1. SIGNS SHALL BE SPACED APPROX. 100 ft. (SEE MUTCD TABLE 6C-1) 2. SECTION 6G-13 Work Within the Travel Way @ Intersection. Note 12 When a lane through an intersection must be closed on the far side, it should also be closed on the near side approach to preclude merging movements within the intersection. 3. SECTION 6G-04- Modification to Fulfill Special Needs - Device spacing may be adjusted to allow additional reaction time. Additional Devices may be used - Arrow Boards. 4. PERSONAL VEHICLE PARKING- IS PROHIBITED IN THE RIGHT AWAY. 5. ALL BIKE TRAFFIC TO TRAVEL IN OPEN LANE WITH MOTOR-VEHICLE TRAFFIC
--

BARRICADES REQUIRE PIN LOCKS IN FEET AND (4) SAND BAGS PER TYPE III	Police Uniformed Traffic Control
DETOUR TRACKERS NEED TO HAVE TWO SANDBAGS ON THEN WHEN SET OUT.	Volunteer for Special Event - Arranged by Peggy
DO NOT PUT ON SIDEWALK OR IN BIKE LANE.	Experienced Certified Flagger - Provided by Traffic Masters
NO LEFTS AND NO RIGHTS SHOULD BE LOCKED ONTO VERTICAL PANELS AND DOUBLED BASED	OLYMPIC Course - Route
	SPRINT BIKE Course - Route

SPECIAL EVENT AHEAD SIGN TO BE PLACED ON SIDE STREETS WITH HIGHER VOLUME TRAFFIC.

